

USB 2.0 On-The-Go microSDHC/XC Card Reader



USB 2.0



INTRODUCTION

The Integral USB OTG (On-The-Go) microSDHC/XC Card Reader features dual USB connectors, so you can move data and media files between microSDHC/XC memory cards and your devices in a fast, convenient way.

A full-sized USB connector provides microSDHC/XC to PC/Mac data transfer and a micro USB connector enables USB On-The-Go; so you can transfer your files to and from your memory card to compatible smartphones and tablet PCs.

FEATURES

- Dual connectors – micro USB and full-size USB
- Transfer data and media files between PCs, Macs, smartphones and tablet PCs
- Supports microSD, microSDHC, microSDXC memory cards
- USB 2.0 data transfer
- PC and Mac compatible

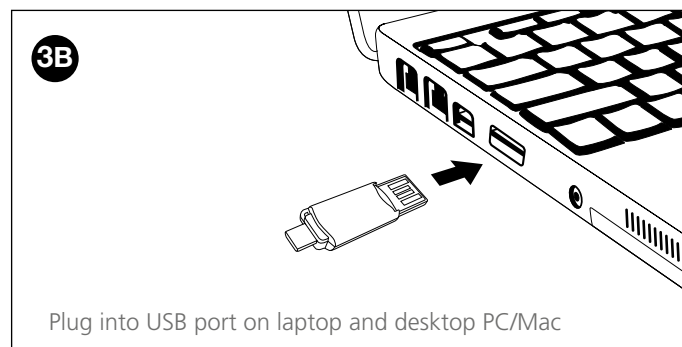
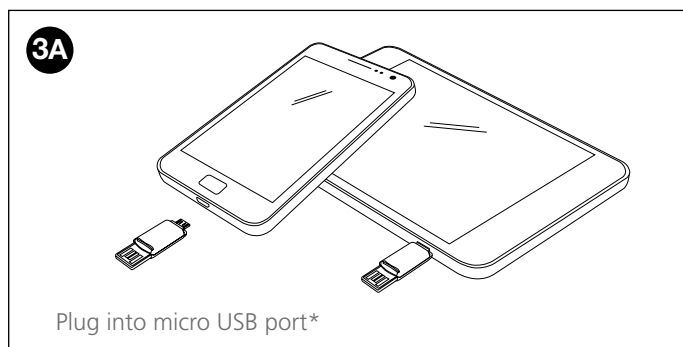
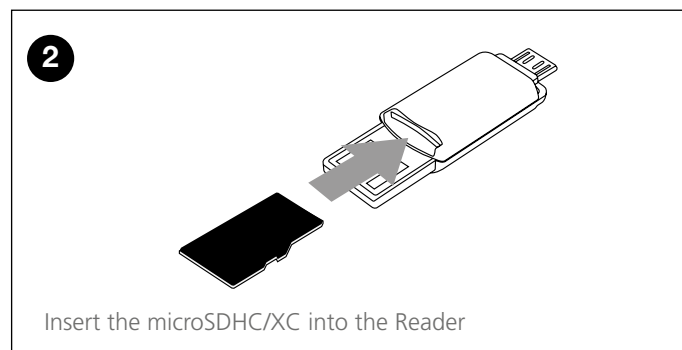
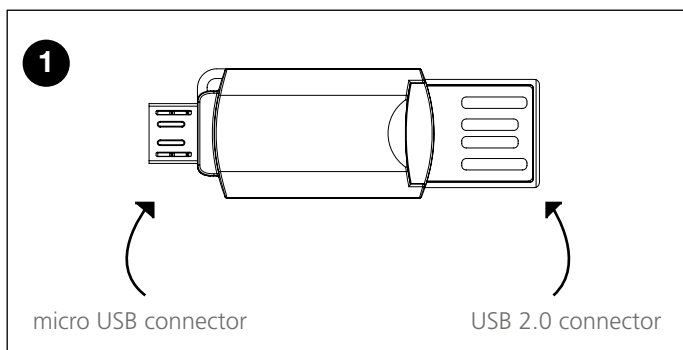

* Your Android™ smartphone/tablet may require an App for On-The-Go compatibility

PRODUCT TYPE

USB Card Reader

INTERFACE TYPE

Hi-Speed USB

INTERFACE CONNECTIVITY

- 1x Hi-Speed USB - 4 Pin USB Type A
- 1x Hi-Speed USB - 5 Pin Micro-USB (B)

COMPATIBILITY

- Windows XP, Vista, 7, 8.1 and 10.
- Mac OS 09 and Later. Linux v2.4.0 and above.

ENVIRONMENTAL PARAMETERS

- Min Operating Temperature 0°C.
- Max Operating Temperature 70°C

COMPLIANT STANDARD

Plug and Play

	LENGTH	WIDTH	DEPTH	WEIGHT
PRODUCT	45mm	14mm	7mm	2g
PACKED	138mm	93mm	6mm	11g

PART CODE	BARCODE (EAN)
INCROTGMSD	5055288430938

Product design and specification subject to change or modification without notice. E&OE.
This device should not be used as your sole backup.
All trademarks acknowledged. 2 year warranty
For warranty information please visit www.integralmemory.com/warranty